

TONWERK 

 **SPEICHERÖFEN**
MADE IN SWITZERLAND

Installation Instruction Tonwerk storage stove

T-ART **eco.0₂**[®]



Contents

1.	Before assembly	3
1.1.	Floor load-bearing capacity:	3
1.2.	Fire protection:.....	3
1.3.	Safe distances:	4
1.4.	Spark protection plate:.....	4
1.5.	Approvals and appliance rating plate:.....	5
1.6.	Fitting the flue gas connection and combustion air supply for ambient air independent operation:	5
1.7.	Supply-air connection underneath / at the rear:	6
1.8.	Connection to a combination air/flue gas chimney:	7
1.9.	Rotating stoves and ambient air independent operation:.....	7
2.	Unpacking the T-LINE:	8
3.	Assembly steps.....	9
3.1.	Step 1:.....	9
3.2.	Installing the stove housing	9
3.3.	Step 2: Flue gas and supply air connections.....	9
3.3.1.	Connecting the combustion air supply for room sealed operation:	9
3.4.	Step 3: Installing the heat storage blocks	11
3.5.	Step 4: Installation of the upper connecting box	13
3.6.	Step 5: Installing the stove cladding.....	15
3.7.	Step 6: Function test – door closure.....	15
3.8.	Step 7: Function test – supply air mechanism	15
3.9.	Step 8: Commissioning, instruction and lighting	16
4.	Turntable option	16
4.1.	Placing the turntable	16
5..	Additional remarks:.....	18

Version 20170202

1. Before assembly

Note



Read these assembly instructions completely before working with the storage stove!

They contain important information for your personal safety.

1.1. Floor load-bearing capacity:

Before assembly, make sure that the load-bearing capacity of the substructure is sufficient to bear the weight of the stove. Strong oscillations of flexible substructures (timber floors) can lead to defects in the stove and make the installation of rotating stoves impossible.

1.2. Fire protection:

CAUTION



CAUTION

Inflammable components, furniture, fabrics, wallpapers, wood panels etc. are to be protected from the effects of heat.

The national and local fire protection rules and regulations apply.

1.3. Safe distances:

CAUTION



CAUTION

Fire prevention laws stipulate minimum or safe distances for inflammable materials (wood panels, panelling, fabrics, etc.). These are given by the table below:

Safe distance A

Sides and rear panels require a minimum distance of 10 cm to inflammable materials

Safe distance B

The national and local rules and regulations are to observe

Safe distance C+D

The entire turning range requires a minimum distance of 50 cm

Safe distance E

The entire turning range requires a minimum distance of 80cm

Safe distance F

The minimum distance to the ceiling is 50 cm

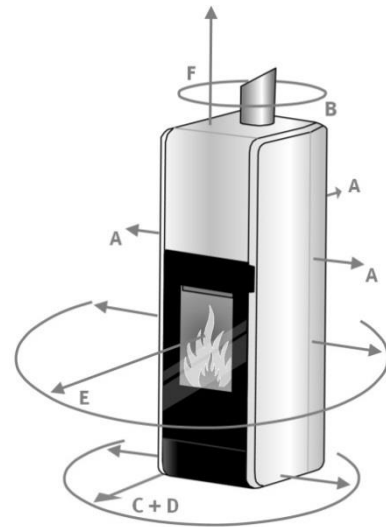

1.4. Spark protection plate:

Flammable floor coverings in front of the stove must be protected by a non-flammable covering. Plates made of stone, ceramic, sheet metal or Securit glass are suitable for this. Flammable floors in front of the stove (carpet, parquet, plastic) must be covered over. Building regulations, state building ordinances and fire protection laws differ from country to country. Enquire to the authority or chimney sweep responsible for the acceptance before installing.

1.5. Approvals and appliance rating plate:

The appliance rating plate provides information about the various approvals carried by the T-LINE. The plate is attached at the bottom on the inner side of the stove door.

In the case of technical enquiries regarding the stove or questions about the warranty, the stove number on the rating plate must always be given in order to be able to identify the stove.



Typ T-ART eco2		Prod. Nr. T7 - 00000 -17	
Leistungserklärung Nr. 007-50143620-1			
Gesamtwärmeabgabe: 19.3 kWh	Mittlere Raumwärmeleistung: 2.6 KW (7.3h Entladezeit)	Abgas-/Verbrennungsluftführung FC61x	
Abgastemperatur: 312 °C	Brenndauer: 2.1 h	Norm: DIN EN 15250-2007-06 / Art. 15a B-VG	
Feinstaub/poussiere/particles: 16 mg/Nm3	CO bei 13% O2: 0.07%		
Energieeffizienz/rendement/efficiency: 81%		Brandsicherheit	erfüllt
Oberflächentemperaturdifferenz: Zeit 100% bis 25% = 7.3 h	Mehrfachbelegung: Ja Brennstoff: Scheitholz	Brandverhalten	A1 WT
		Oberflächentemperatur	erfüllt
		Elektrische Sicherheit	nicht zutreffend
		Maximaler Betriebsdruck	NPD
		Mechanische Festigkeit	NPD
		Freisetzung Gefährlicher Stoffe	NPD
Hersteller: Tiba AG, Hauptstrasse 147, CH-4416 Bubendorf		NPD = no performance determined / keine Leistungsbestimmung	
Bedienungsanleitung beachten/lire le manuel/read instruction manual!			

Flue gas mass flow	g/s	7.0
Flue gas temperature	°C	312
Necessary pressure difference	Pa	11

1.6. Fitting the flue gas connection and combustion air supply for ambient air independent operation

The flue gas evacuation system and combustion air supply must be designed pursuant to the FC61x classification in the case of balanced flue operation and evidence to this effect must be provided pursuant to **DIN EN 13384-1:2008-08** and **DIN EN 13384-2:2009-07**.

Tonwerk Lausen AG recommends and supplies the **Lindab** connecting system for the combustion air supply. The required elements must be specified when ordering.

The joints of individual connecting elements of the combustion air supply must be tightly sealed.

Flue pipe connections at the stove and wall must be sealed.

By room air independent operation with automatic air ventilation for the housing space, it's only allowed a chimney multi configuration when the installation is in the same housing unit.

1.7. Supply-air connection underneath / at the rear T-ART

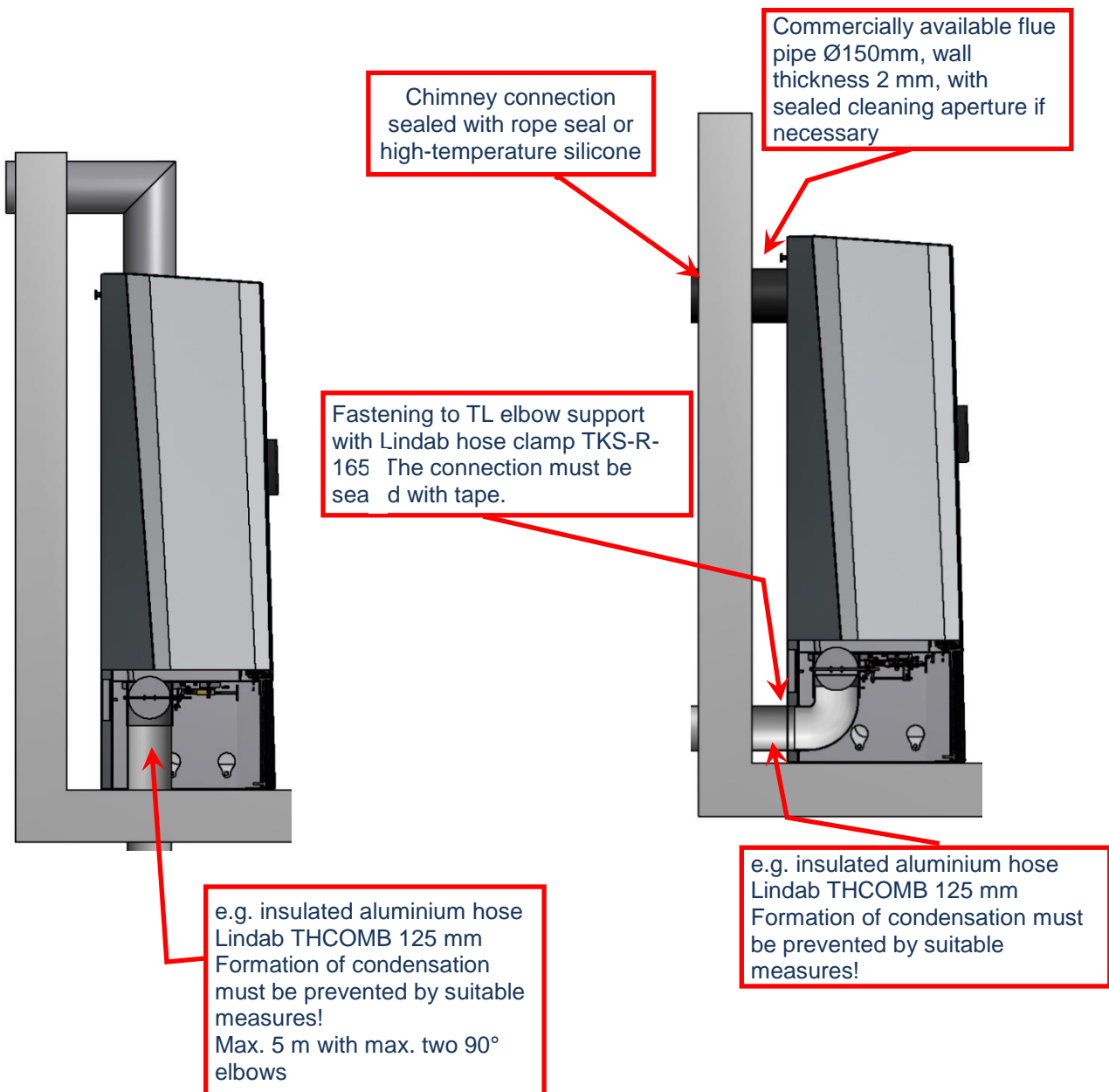

1.8 Connection to a combination air/flue gas chimney

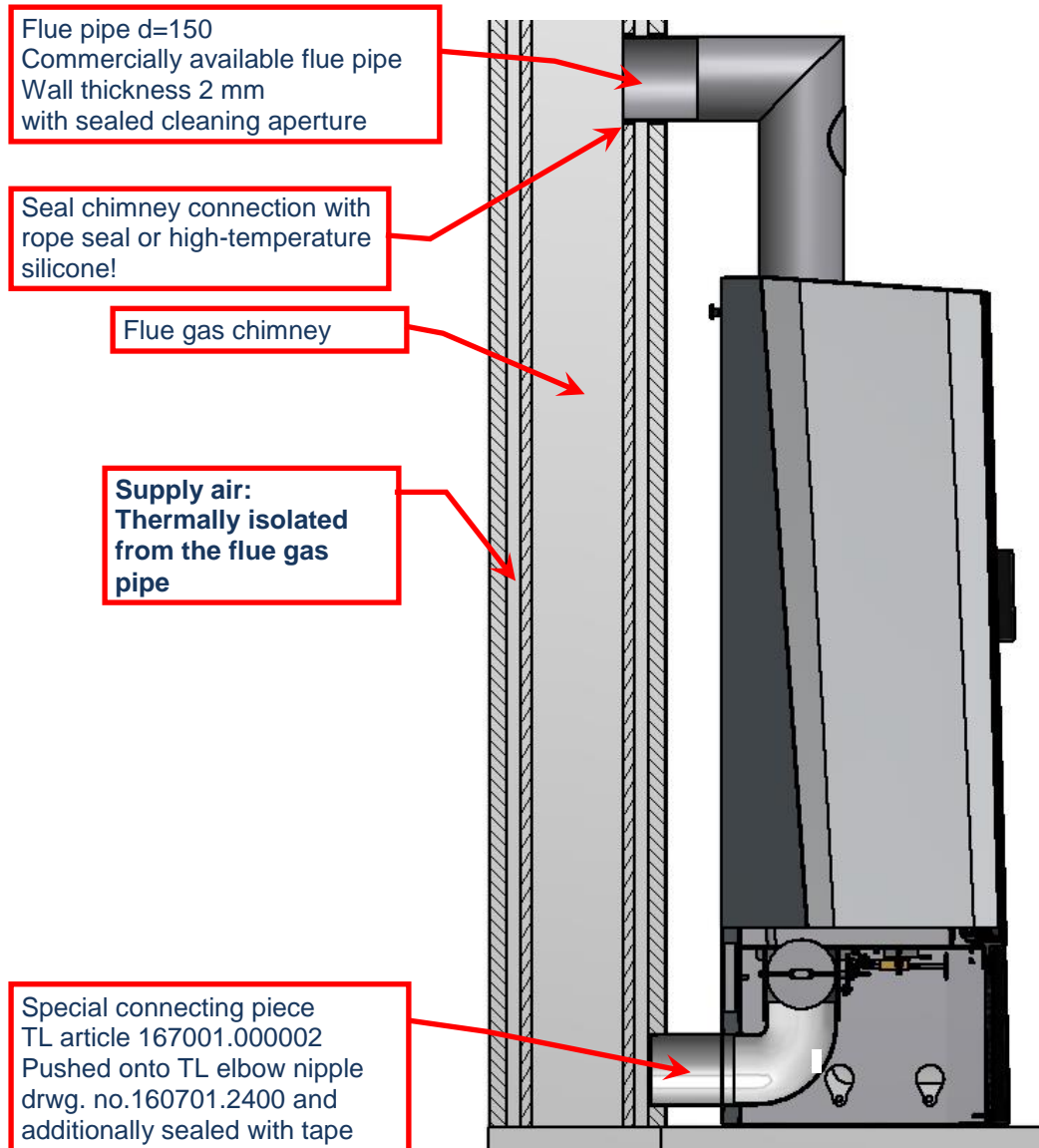

1.9. Rotating stoves and ambient air independent operation

Note



Rotating connections with standard rotating brackets and flue gas connecting pieces are accessories which are **not** suitable for room sealed operation and are hence not permitted.

2. Unpacking the T-LINE:

Note



Make sure when unpacking that the edges of the cladding elements are not damaged. **A stone edge is easily damaged!** The glass of the fire door is likewise endangered. Each appliance is assembled and checked for completeness and damage during the works acceptance. However, if you should find defects that are attributable to transport damage, contact Tonwerk Lausen AG **immediately after delivery.**

WARNING



Heavy components

Components can be very heavy. Inappropriate handling leads to serious injuries!

Use suitable lifting equipment and aids!

3. Assembly steps

3.1. Step 1:

See turntable option for versions with a turntable!

3.2. Installing the stove housing

Level the housing and align and measure for the chimney connection taking the upper sheet metal cover as the basis.

Note



The stove can no longer be moved once assembly is complete.

The housing must stand on an even floor or a baseplate. If the surface is uneven, the housing can be levelled by means of the four set screws.

CAUTION



CAUTION!

In the case of glass baseplates: Use the set screws only with wide metal underlays

3.3. Step 2: Flue gas and supply air connections

3.3.1. Connecting the combustion air supply for room sealed operation:

The supply air can be tightly connected vertically downwards or horizontally to the rear using commercially available flexible aluminium pipe with a diameter of 125 mm.

A suitable connecting elbow is to be used when connecting the supply air at the rear.

The T-LINE connection is equipped with a commercially available connecting piece with a sealing lip, which prevents the flexible aluminium pipe from slipping out.

Note



The free cross-section of 125 mm may not be reduced.

In particular when connecting to the exterior facade, care must be taken that the supply air pipes are adequately insulated in order to prevent the formation of condensation.

IMPORTANT



Important!

In the case of long supply air pipes > 4 m or several changes of direction (elbows), the flow resistance is to be compensated by adaptation of the dimensioning. It is recommended to calculate the dimension of the supply air pipe using the chimney calculation program.

3.4. Step 3: Installing the heat storage blocks

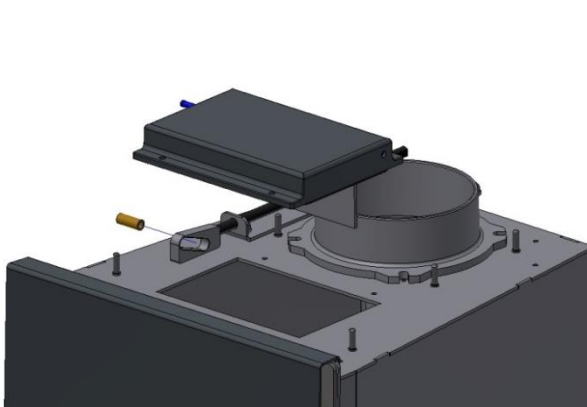

1. Position the stove housing
2. Unscrew the start-up flap

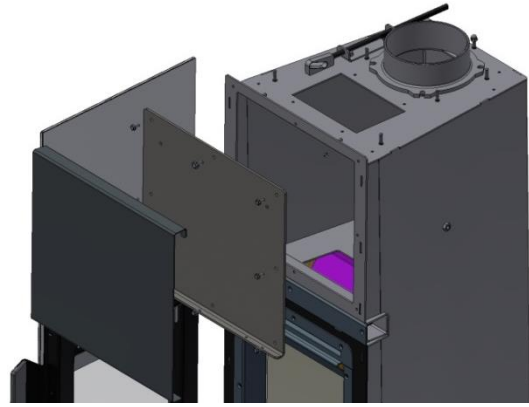

3. Remove the sheet metal screen
4. Unscrew the storage cover

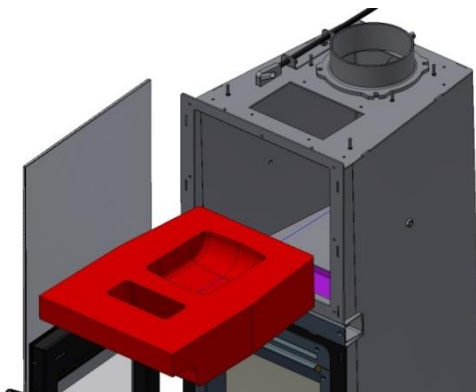

5. Insert the bottom storage stone and push it right to the back. The stone must be in a horizontal position

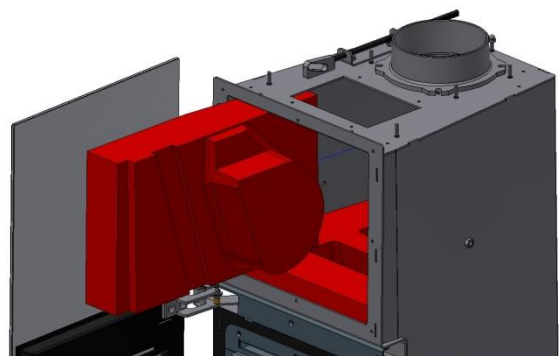

6. Clean the surface of the bottom storage stone
7. Slide the top lateral storage stone in until it is positioned at the rear of the housing

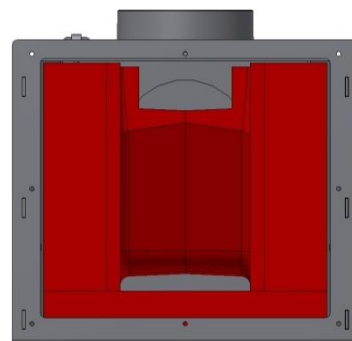
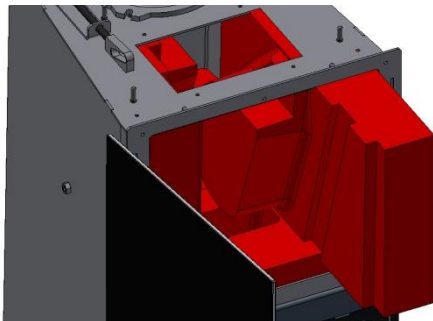

8. Also slide the second storage stone in as far as the stop on the rear panel of the housing
9. Secure both lateral stones using the screws attached to the side of the housing

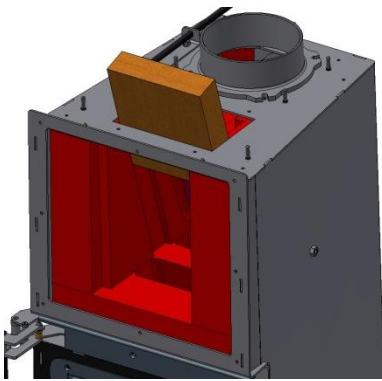

10. Slide the flue gas baffle plate in from above

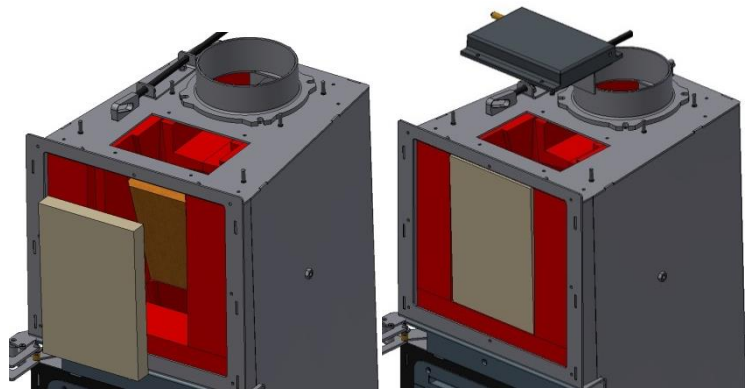

11. Insert the front storage plate and refit the start-up flap at the top
12. Test the function of the start-up flap

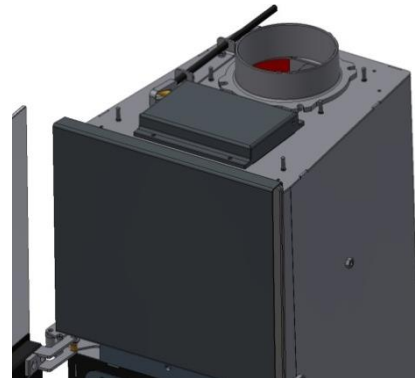
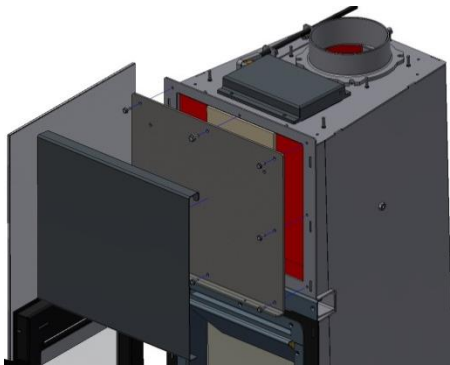

13. Refit the storage cover and ensure that the seal is positioned correctly
14. Refit and screw down the top sheet metal screen

Note



It must be ensured that the heat storage blocks are installed flush with the edge of the housing at the sides and the rear and that no great gap between the storage stones is created.

Note



It's important that the flue pipe connection and the cleaning opening must be tightly. This also applies the transitions between nozzles to chimney and flue pipe to ceiling connection or wall connection.

3.5. Step 4: Installation the stove cladding



1. Carefully mount the left side plate at the bottom of the housing with the centring pin (A) and turn it to the front

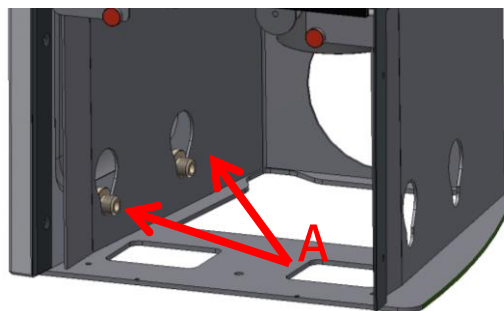

2. Turn the side plate to the front, aligning it with the pane of glass; the side plate should be approx. 2mm back from the pane of glass

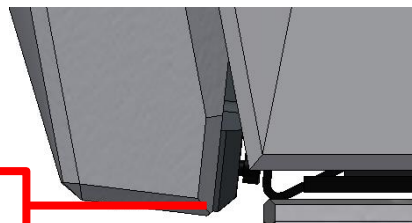

2 mm



Screw on the top side plate (B) and, after aligning it, at the bottom secure the centring pin with the lock nut

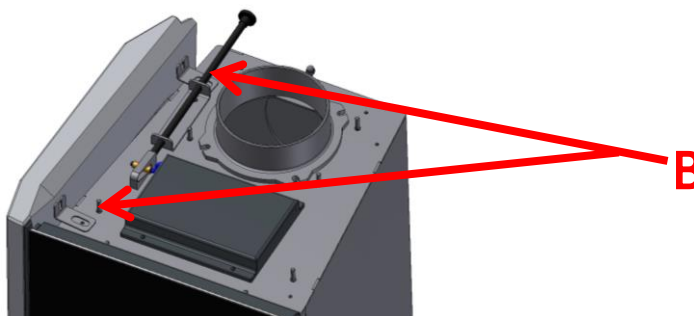

3. The door must be opened and locked before the right side plate can be mounted. Fit and align in the same way as for the left plate

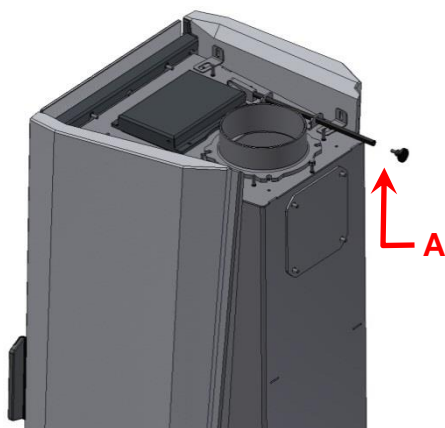

4. Unscrew the start-up flap control knob (A), mount the rear panel (B) and screw down at the top and bottom

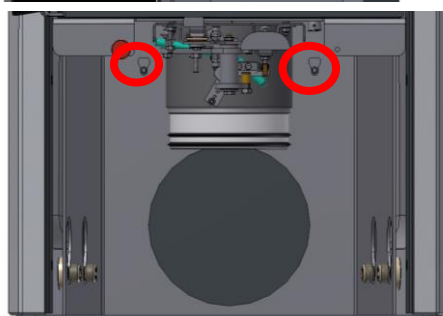
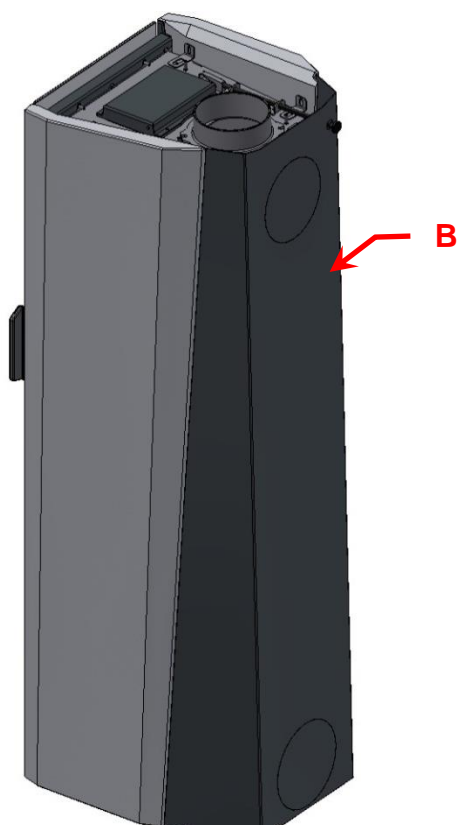
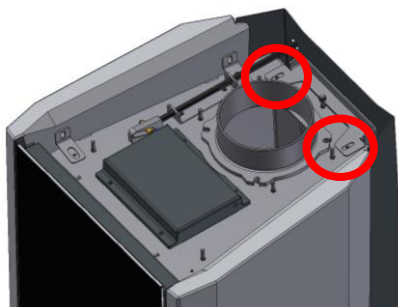

Screw the control knob back on

5. Place the cover stones back on top

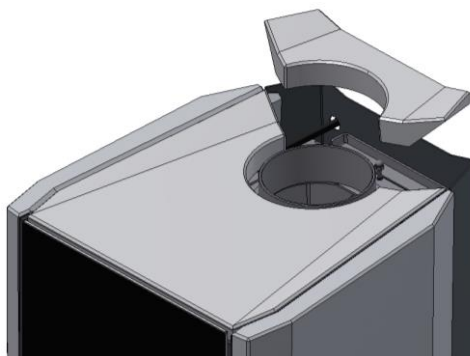

3.6. Step 6: Function test – door closure

Note



Before putting into operation, check that the locking lever of the closing mechanism moves beyond dead centre to the stop and locks the door properly.

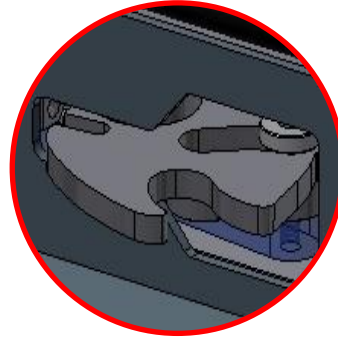

3.7. Step 7: Function test – supply air mechanism

Note



- (1) Before connecting the supply air, check that the air flap closes by pressing the reset button (audible closing noise).
- (2) Check whether the supply air flap is opened again by opening the door.
- (3) With the door closed, close the supply air flap with the reset button again.

Points 1 to 3 must be repeated several times.

3.8. Step 8: Commissioning, instruction and lighting

Light the stove and instruct the user on the basis of the operating manual. Draw the customer's attention to the safety and application information.

Note



Inform the customer that a defective seal must be replaced immediately for safety reasons.

4. Turntable option

4.1. Placing the turntable

In the case of a stove with a turntable, this must be placed on the floor first.

Note



It is **important** that the turntable rests flat and even with its whole surface on the floor.

- (1) The turntable must be always placed in the bisecting axis of the desired angle of rotation

e.g.

90° angle of rotation, bisector = 45°

- (2)

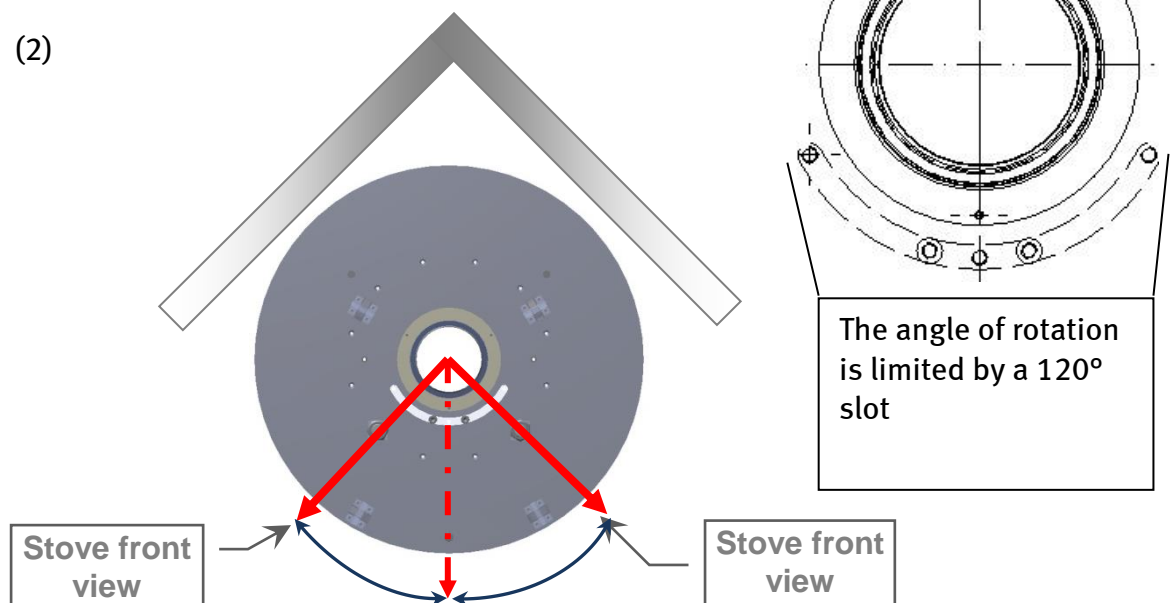

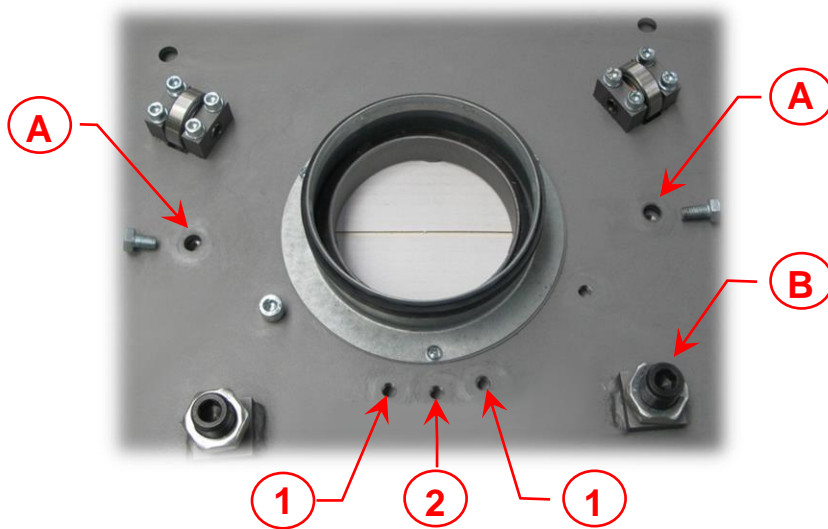

- A These holes are for fixing the turntable (delivery condition)
 - B Latching bolts for latching in the desired position
Assembly = screw in to the stop, then $\frac{1}{2}$ turn back out, secure with lock nut
- 1) Stop for 45° angle of rotation
(Total angle of rotation = 90° grad)
 - 2) Stop for 60° angle of rotation
(Total angle of rotation = 120° grad)

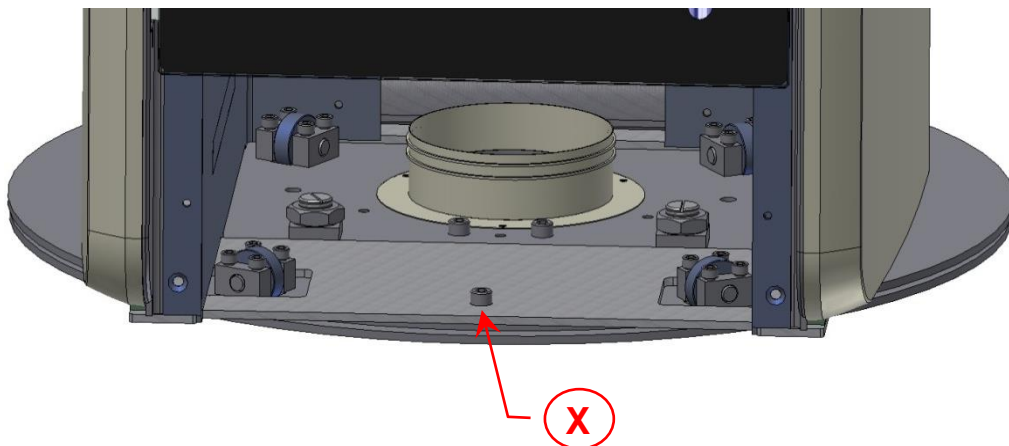

- x) Stove is bolted to the turntable using this bolt

5. Additional remarks:

In case of use of ventilation grilles or supply air flaps on the exterior façade, the customer must be instructed regarding maintenance/cleaning.

Complete the warranty certificate in the presence of the customer and return it to us.

Please contact our Customer Service Dept. on +41 (0) 61 935 17 10 if you should have any questions.

Subject to change without notice: Bubendorf, February 2017

info@tonwerk-ag.com
www.tonwerk-ag.com

Tiba AG

Hauptstrasse 147
CH-4416 Bubendorf

Telefon: +41 (0) 61 935 17 10
Fax: +41 (0) 61 931 11 61